

## SHIRE OF YORK

### APPLICATION FOR A STANDARD CROSSOVER IN A RESIDENTIAL AREA

---

**STEP 1. APPLICATION – Landholder to complete (also page 3)**

Name		
Postal address		
Property address		
Contact phone		Mobile
<b>I have not previously made application to the Council for a crossover subsidy on this land. This property is not subject to a Subdivision, Amalgamation or Boundary Re-alignment.</b>		
Signature		Date

**STEP 2. APPROVAL – by Works Supervisor prior to commencement**

Site inspection	Pipe size	Date
Comments / amendments		
Signature		Date

**STEP 3. CROSSOVER – Works by Contractor**

---

**STEP 4. COMPLETION – Certification by Contractor**

Name		
Postal address		
Contact phone		Mobile
<b>Work has been completed as per specification and location plan.</b>		
Signature		Date

**STEP 5. PAYMENT – Authorisation by Works Supervisor (not applicable for subdivisions, amalgamations or boundary realignments)**

Final inspection	Approved	YES / NO
Comments		
Signature		Date

SHIRE OF YORK

SAMPLE LOCATION PLAN

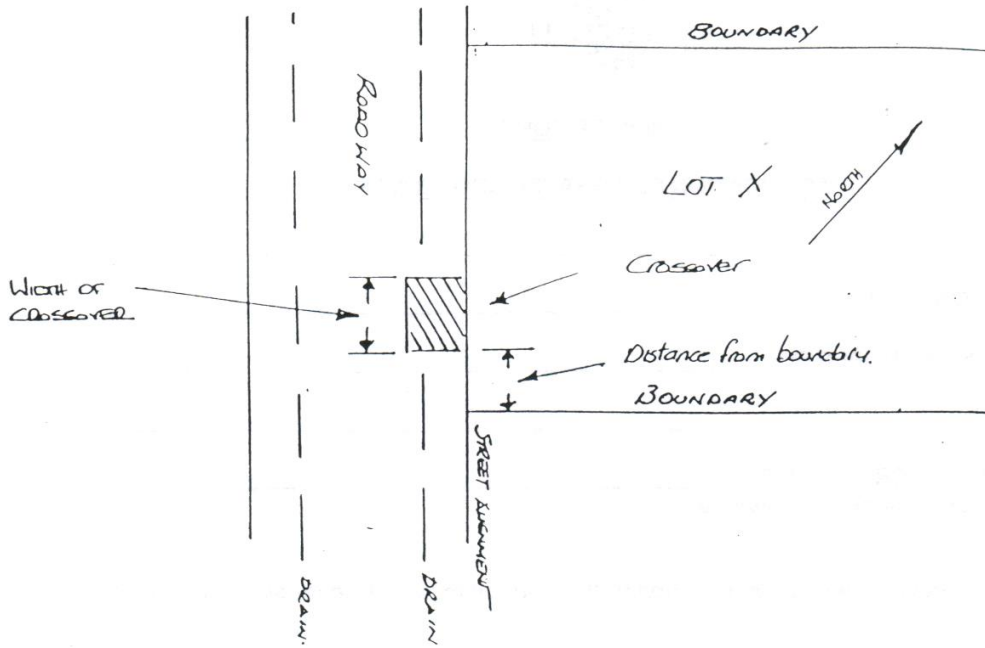

HEADWALLS CONSTRUCTION

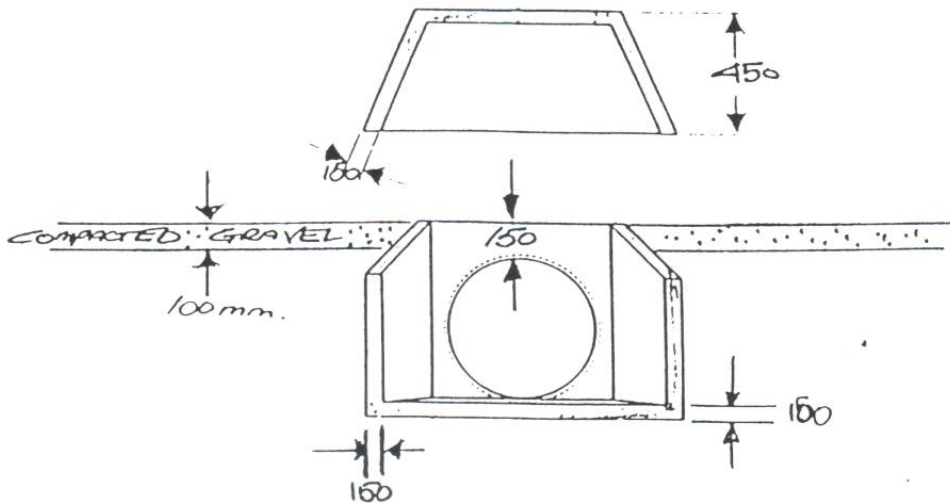

## LOCATION PLAN

1. Show road, house and lot numbers, north point, location of power poles, fences, buildings etc.
  2. Show dimensions and distance to clearly identify the position of the crossover.
-

**SHIRE OF YORK**  
**SPECIFICATIONS FOR STANDARD CROSSOVER CONSTRUCTION**

---

1. Council will provide a subsidy only on roads under Council control. Crossovers on the following roads are under the control of Main Roads WA, and application should be made to them –
  - a. York-Quairading
  - b. Northam-York
  - c. Great Southern Highway
  - d. York-Perth
2. Only one crossover subsidy will be paid to each separate rate assessment.
3. Prior to constructing any crossover within a road reserve, an application showing the proposed location and other details is required (Application for Crossover).
4. Prior to commencing any work, Council's Works Supervisor will inspect the site and provide written approval or requirement for alteration to the location. The approval will specify the size of pipe, if required.
5. Crossovers are to be constructed to the following specifications –
  - a. Crossovers shall not be less than 3 metres in width to a maximum width of 6 metres.
  - b. The crossover area shall be boxed out to a minimum depth of 100 mm from the pavement to the boundary, and graveled.
  - c. The gravel fill is to be graded and compacted to the satisfaction of the Works Supervisor.
  - d. The crossover is to be constructed so as to have an evenfall, avoiding any hump at any pipe installed.
  - e. Approved crossover finishing materials are concrete, bitumen and brick paving for all residential crossovers in accordance with the R-Codes.
6. Where pipes are required –
  - a. The pipes are to be installed so that they have a minimum of 100 mm compacted gravel cover.
  - b. Concrete headwalls shall have a minimum thickness of 150 mm concrete (20MDA), and must extend at least 150 mm above the pipe
  - c. A concrete apron shall be constructed with a minimum thickness of 100 mm and shall extend at least 450 mm from the end of the pipe.
  - d. Concrete wing walls at least 150 mm thick shall extend from the pipe to the end of the apron.
7. Crossover subsidy will be paid as follows –

Standard crossover is 4 metres wide, piped with rock/concrete headwalls as necessary, graveled and compacted and finished with concrete, bitumen or brick paving.  
The portion of a crossover in excess of the standards is not subsidised by Council.  
Subsidy is not applicable on MRWA verges.

NO SUBSIDY IS APPLICABLE TO SUBDIVISIONS, AMALGAMATIONS OR BOUNDARY REALIGNMENTS.

The standard crossover bond to clear subdivisions, amalgamations and boundary realignments is \$1650.00 per lot including existing lots.
8. Work in excess of that specified above is fully at the landowner's cost, and will not be subsidised by Council.
9. Payment of the subsidy will not be made until the work is complete, and has been inspected and is authorised by the Works Supervisor.